

ANSI/BHMA A156.7-2016 American National Standard For Template Hinge Dimensions

The purpose of this Standard is to establish nationally recognized dimensions for builders template hinges which are used on metal doors and frames. This Standard is intended to assure the interchangeability of template hinges and to provide a uniform method for template identification. This Standard covers the requirements for the length, width, thickness, offset, and screw hole spacing for builders template hinges. Included in the standard are hinge identification symbols and screw sizes. Methods for identifying template hinges that conform to the Standard are provided. For further information, consult the full standard, ANSI/BHMA A156.7 for Template Hinge Dimensions.

BHMA has created this series of *Hardware Highlights* to provide useful, accessible information about builders hardware for anyone with an interest in devices that hang, control, secure, and trim the doors. BHMA is the trade association which represents almost all of the North American manufacturers of builders hardware. One of its main activities since 1983 has been the development and maintenance of ANSI-approved standards for 35 separate product categories.

Sample Template

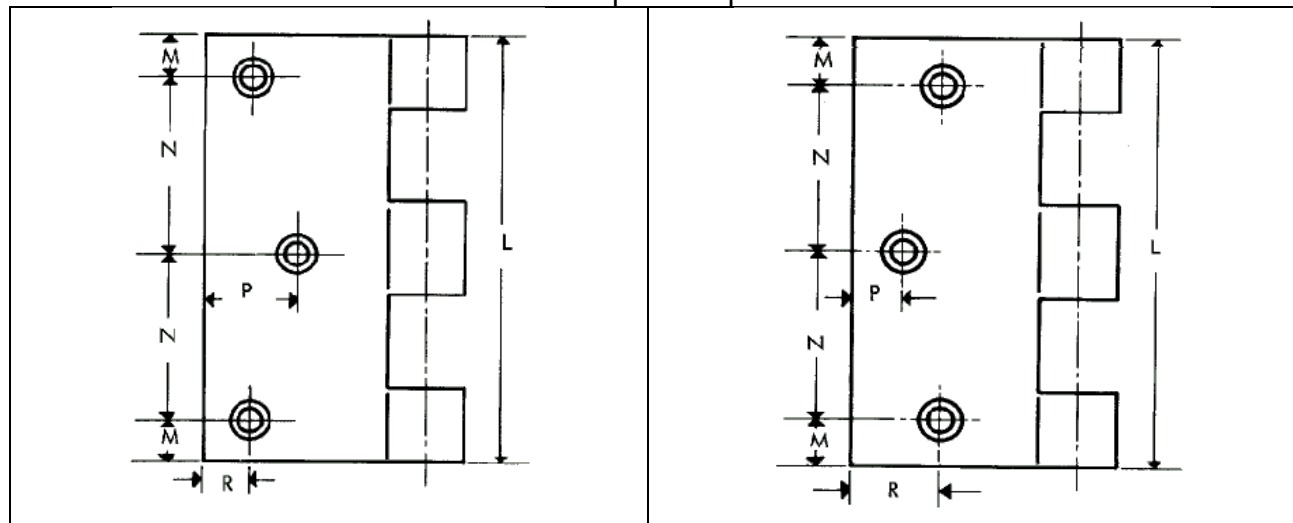

Figure 2.
Full mortise template hinges 2.5 in (63.5 mm)
and 3 in (76.2 mm) sizes (A25M & A30M)

Figure 3.
Full mortise template hinge 3.5 in (88.9 mm)
size (A35M)

Symbol	A25M		A30M		A35M	
Dimensions	inches	mm	inches	mm	inches	mm
L	2.500	63.50	3.000	76.20	3.500	88.90
M	0.312	7.92	0.312	7.92	0.355	9.02
N	0.938	23.83	1.188	30.18	1.395	35.43
P	0.516	13.11	0.580	14.73	0.360	9.14
R	0.320	8.13	0.312	7.92	0.687	17.45
Thickness	0.089	2.26	0.092	2.34	0.123	3.12
Machine Screws	8-32 Flat Head		10-24 Flat Head		10-24 Flat Head	